



SUB H12

PASSIVE SUBWOOFER

Subwoofer series takes advantage of tremendous experience in touring, installation and mobile markets. Cabinets are equipped with next-generation transducers with reinforced moving system capable of withstanding tremendous pressure and excursion while keeping distortion in check.

Sub H12 is a dedicated arrayable subwoofer with integrated flying hardware, compatible with Wasp line array cabinets full-range cabinets. It is equipped with high-power 12" woofer installed into effective hybrid horn enclosure.

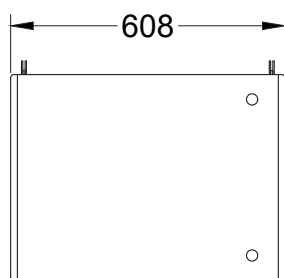
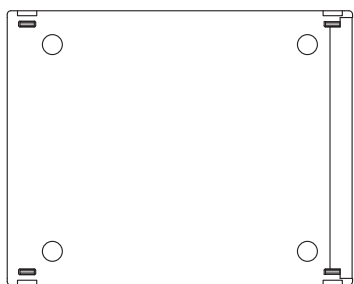
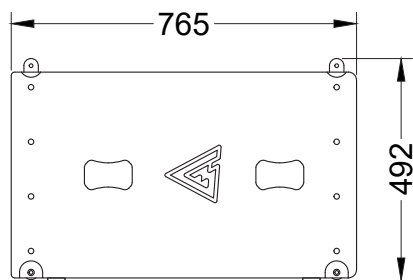

Main features:

- 950W nominal power
- 12" woofer with 4" voice coil
- Efficient hybrid horn design
- 140 dB Max SPL
- Integrated flying hardware

Frequency Response (-10dB)	42 - 140 Hz
Max SPL ¹	140 dB
Sensitivity (1W/1m)	101 dB
LF Driver	12", 4" VC
Impedance	8 Ohm
Nominal power ²	950 W
Connectors	4x NeutrikSpeakon
Dimensions (W×H×D), mm	608x492x765 mm
Net weight, kg	44,6 kg
Shipping weight, kg	47,6 kg
Mounting	Intergrated flying hardware
Enclosure material	Plywood; wear-resistant paint
Grill	Steel grill, acoustically transparent foam

¹ - peak value, calculated according to AES 2 - 2012

² - based on transducer power measured according to AES 2 - 2012

With dedication to constant improvement of the products, manufacturer may change the listed specifications without prior notice