

Kramer Electronics, Ltd.



USER MANUAL

Model:

901

Personal Stereo Amplifier

Contents

| | | |
|----------|--|----------|
| 1 | Introduction | 1 |
| 2 | Getting Started | 1 |
| 3 | Your Personal Stereo Amplifier | 1 |
| 4 | Using the Personal Stereo Amplifier | 3 |
| 4.1 | Connecting the Personal Stereo Amplifier | 3 |
| 4.2 | Operating the Personal Stereo Amplifier | 3 |
| 5 | Technical Specifications | 4 |

Figures

| | | |
|-----------|--|---|
| Figure 1: | 901 Personal Stereo Amplifier | 2 |
| Figure 2: | Connecting the 901 Personal Stereo Amplifier | 4 |

Tables

| | | |
|----------|---|---|
| Table 1: | Features and Functions of the 901 Personal Stereo Amplifier | 2 |
| Table 2: | Technical Specifications of the 901 Personal Stereo Amplifier | 4 |

1 Introduction

Dedication by Kramer Electronics since 1981, to the development and manufacture of high quality video/audio equipment, makes the Kramer line an integral part of the finest production and presentation facilities in the world. In recent years, Kramer has redesigned and upgraded most of the line, making the best even better! The Kramer line of professional video/audio electronics is one of the most versatile and complete available, and is a true leader in terms of quality, workmanship, price/performance ratio and innovation. In addition to our high quality accessories, like the Kramer **TOOLS 901 Personal Stereo Amplifier**, we also offer excellent switchers and matrices, distribution amplifiers, presentation processors, interfaces, remote controllers and computer-related products. Congratulations on purchasing your Kramer **901 Personal Stereo Amplifier**. This product is ideal for:

- Presentation rooms and multimedia applications for quick, local audio amplification

- Personal audio listening¹

The package includes the following items:

- **901 Personal Stereo Amplifier**
- Power adapter (12V DC Input)
- This user manual
- Kramer concise product catalog/CD

2 Getting Started

We recommend that you:

- Unpack the equipment carefully and save the original box and packaging materials for possible future shipment
- Review the contents of this user manual

3 Your Personal Stereo Amplifier

The high performance **901 Personal Stereo Amplifier** can output up to 4-Watts peak power, which is ample for personal and small presentation applications. The **901** includes:

- Control knobs to adjust volume, bass, treble and balance
- Selector switches to select the mic or line inputs and the type of microphone (condenser or dynamic)

¹ For example, PC and portable CD player

- Outputs for a headphone set and for a pair of loudspeakers

Achieving the best performance means:

- Connecting only good quality connection cables, thus avoiding interference, deterioration in signal quality due to poor matching, and elevated noise levels (often associated with low quality cables)
- Avoiding interference from neighboring electrical appliances that may adversely influence signal quality and positioning your Kramer **901** in a location free from moisture and away from excessive sunlight and dust

Figure 1 and Table 1 define the **901 Personal Stereo Amplifier**:

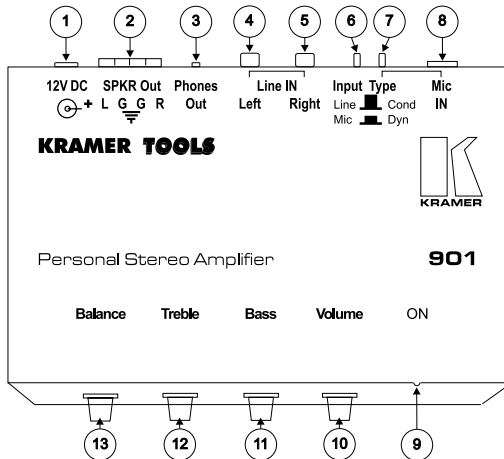

Figure 1: 901 Personal Stereo Amplifier

Table 1: Features and Functions of the 901 Personal Stereo Amplifier

| # | Feature | Function |
|----|---|---|
| 1 | 12V DC | +12V DC connector for powering the unit |
| 2 | SPKR Out (LGGR) Terminal Block Connectors | Connect to the pair of loudspeakers |
| 3 | Phones Out connector | Connects to the headphone set |
| 4 | Line IN (Left) RCA connector | Connects to the left stereo audio line level input |
| 5 | Line IN (Right) RCA connector | Connects to the right stereo audio line level input |
| 6 | Input Line/Mic Selector Switch | Pushing in selects the Mic input, releasing selects the line input |
| 7 | Type Cond/Dyn Selector Switch | Pushing in selects the dynamic microphone, releasing selects the condenser microphone |
| 8 | Mic IN | Connects to the microphone |
| 9 | ON LED | Illuminates when receiving power |
| 10 | Volume Control Knob | Controls the signal output level |
| 11 | Bass Control Knob | Controls the bass (low frequencies) |
| 12 | Treble Control Knob | Controls the treble (high frequencies) |
| 13 | Balance Control Knob | Adjusts the balance between the right and left channels |

4 Using the Personal Stereo Amplifier

Sections 4.1 and 4.2 describe how to connect and how to operate your **901 Personal Stereo Amplifier**, respectively.

4.1 Connecting the Personal Stereo Amplifier

Connect your **901**, as Figure 2 illustrates:

1. Connect one or both of the following inputs:
 - A stereo audio source (for example, a DVD Player) to the *Left* and *Right Line IN* connectors; and /or
 - A microphone to the *Mic IN* input
2. Connect one or both¹ of the following outputs:
 - A pair of loudspeakers to the *SPKR Out* connector, by connecting the left loudspeaker to the “*L*” (left) terminal block connector and to the adjacent “*G*” (Ground) terminal block connector. Connect the right loudspeaker to the “*R*” (right) terminal block connector and to the adjacent “*G*” (Ground) terminal block connector; and /or
 - A headphone set to the *Phones Out* connector
3. Connect the 12V DC power adapter to the power socket and connect the adapter to the mains electricity.

4.2 Operating the Personal Stereo Amplifier

Operate your **901**, as Figure 2 illustrates:

1. Choose the active audio source² via the *Input Line/Mic* selector switch.
 - Push in the *Input Line/Mic* selector switch to choose the *Mic IN* input. When choosing a microphone, choose a dynamic microphone or condenser via the *Type Cond/Dyn* selector switch³
 - Release the *Input Line/Mic* selector switch to choose the *Line IN* input
2. Adjust the volume, bass, treble and balance controls as required.

¹ Signals from both outputs (the headphones and the pair of loudspeakers) flow simultaneously. When the 901 is functioning, connecting a headphone set to the Phones Out connector will not automatically disconnect the pair of loudspeakers

² That is, either the stereo audio source or the Mic

³ Push in the Type Cond/Dyn selector switch to choose the Dynamic microphone input. Release the Type Cond/Dyn selector switch to choose the Condenser input

Technical Specifications

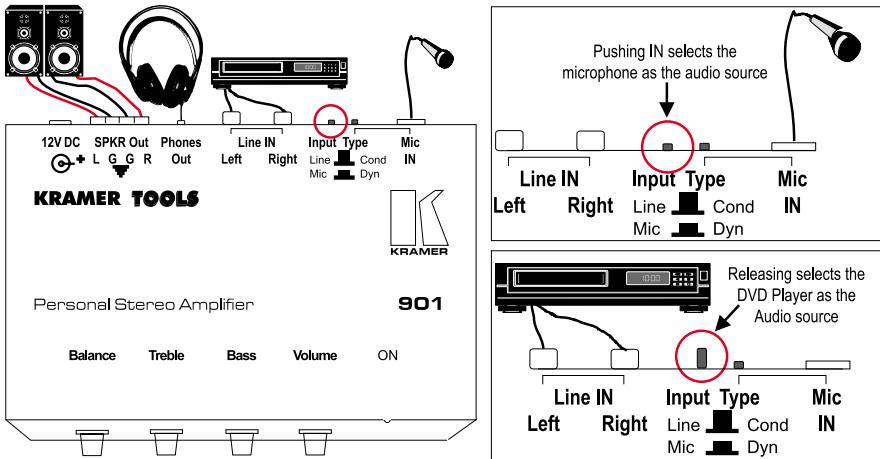

Figure 2: Connecting the 901 Personal Stereo Amplifier

5 Technical Specifications

Table 2: Technical Specifications of the 901 Personal Stereo Amplifier

| | |
|---------------|--|
| Inputs: | Stereo audio line level input, Mic input |
| Outputs: | Stereo loudspeaker terminal block; Headphones |
| Bandwidth: | 37 kHz -3dB |
| S/N Ratio: | 75 dB unweighted |
| THD + Noise: | 0.06% @ 1kHz, 1 Volt |
| Controls: | Input Line/Mic and Type Cond/Dyn selector switches, volume, bass, treble and balance control knobs |
| Output Power: | 5.7 W RMS/Channel into 8 ohms |
| Dimensions: | 12 cm x 7.5 cm x 2.5 cm (4.7" x 2.95" x 0.98", W, D, H) |
| Power Source: | 12 VDC, 60mA |
| Weight: | 0.3 kg (0.66lbs.) approx. |
| Accessories: | Power supply, mounting bracket |

LIMITED WARRANTY

Kramer Electronics (hereafter *Kramer*) warrants this product free from defects in material and workmanship under the following terms.

HOW LONG IS THE WARRANTY

Labor and parts are warranted for three years from the date of the first customer purchase.

WHO IS PROTECTED?

Only the first purchase customer may enforce this warranty.

WHAT IS COVERED AND WHAT IS NOT COVERED

Except as below, this warranty covers all defects in material or workmanship in this product. The following are not covered by the warranty:

1. Any product which is not distributed by Kramer, or which is not purchased from an authorized Kramer dealer. If you are uncertain as to whether a dealer is authorized, please contact Kramer at one of the agents listed in the web site www.kramerelectronics.com.
2. Any product, on which the serial number has been defaced, modified or removed.
3. Damage, deterioration or malfunction resulting from:
 - i) Accident, misuse, abuse, neglect, fire, water, lightning or other acts of nature
 - ii) Product modification, or failure to follow instructions supplied with the product
 - iii) Repair or attempted repair by anyone not authorized by Kramer
 - iv) Any shipment of the product (claims must be presented to the carrier)
 - v) Removal or installation of the product
 - vi) Any other cause, which does not relate to a product defect
 - vii) Cartons, equipment enclosures, cables or accessories used in conjunction with the product

WHAT WE WILL PAY FOR AND WHAT WE WILL NOT PAY FOR

We will pay labor and material expenses for covered items. We will not pay for the following:

1. Removal or installations charges.
2. Costs of initial technical adjustments (set-up), including adjustment of user controls or programming. These costs are the responsibility of the Kramer dealer from whom the product was purchased.
3. Shipping charges.

HOW YOU CAN GET WARRANTY SERVICE

1. To obtain service on you product, you must take or ship it prepaid to any authorized Kramer service center.
2. Whenever warranty service is required, the original dated invoice (or a copy) must be presented as proof of warranty coverage, and should be included in any shipment of the product. Please also include in any mailing a contact name, company, address, and a description of the problem(s).
3. For the name of the nearest Kramer authorized service center, consult your authorized dealer.

LIMITATION OF IMPLIED WARRANTIES

All implied warranties, including warranties of merchantability and fitness for a particular purpose, are limited in duration to the length of this warranty.

EXCLUSION OF DAMAGES

The liability of Kramer for any effective products is limited to the repair or replacement of the product at our option. Kramer shall not be liable for:

1. Damage to other property caused by defects in this product, damages based upon inconvenience, loss of use of the product, loss of time, commercial loss; or:
2. Any other damages, whether incidental, consequential or otherwise. Some countries may not allow limitations on how long an implied warranty lasts and/or do not allow the exclusion or limitation of incidental or consequential damages, so the above limitations and exclusions may not apply to you.

This warranty gives you specific legal rights, and you may also have other rights, which vary from place to place.

NOTE: All products returned to Kramer for service must have prior approval. This may be obtained from your dealer.

This equipment has been tested to determine compliance with the requirements of:

- EN-50081: "Electromagnetic compatibility (EMC);
generic emission standard.
Part 1: Residential, commercial and light industry"
- EN-50082: "Electromagnetic compatibility (EMC) generic immunity standard.
Part 1: Residential, commercial and light industry environment".
- CFR-47: FCC Rules and Regulations:
Part 15: "Radio frequency devices
Subpart B – Unintentional radiators"

CAUTION!

- Servicing the machines can only be done by an authorized Kramer technician. Any user who makes changes or modifications to the unit without the expressed approval of the manufacturer will void user authority to operate the equipment.
- Use the supplied DC power supply to feed power to the machine.
- Please use recommended interconnection cables to connect the machine to other components.



The list of Kramer distributors appears on our web site:
www.kramerelectronics.com

We welcome your questions, comments and feedback.

Kramer Electronics, Ltd.

3 Am VeOlamo Street. Jerusalem 95463, Israel Tel: (+972-2)-654-4000

Fax: (+972-2)-653-5369, E-mail: kramereel@netvision.net.il

P/N: 2900-006013 REV 1